

**30 Jellicoe,  
Rosebank,  
Gauteng**

# Unlock the potential of space

A space is more than its surface area and walls; it's a canvas for human experience. More than structure and aesthetics, spaces enable connections and inspire. Spaces engage us; they are sensory and invite interaction. They draw us in and influence our wellbeing. Spaces hold history. They can be imagined and reimaged. At Investec Property, we don't just look at how a space is, but at how it can be and what it can bring to people's lives. We see the value it holds and the opportunities it presents. We see the potential of space.

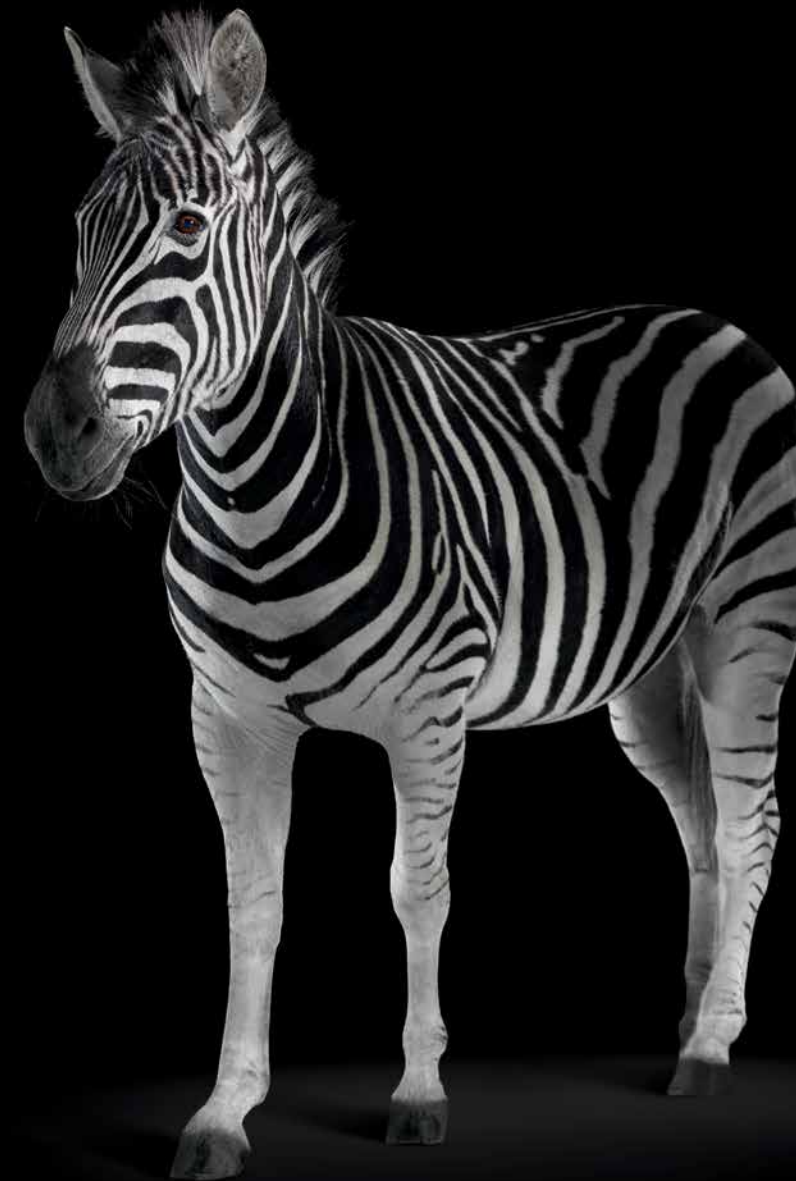

## **Location**

We get the fundamentals right. Everything we've achieved is built on the understanding that location is strategic. Once we have the right location and understand the context of the space, we begin to imagine how we can repurpose it to its full potential. Then, we create a sought-after environment that both complements and adds to its surrounds. It's how we develop quality assets that hold value and deliver attractive long-term returns.

## **Relation**

We engage with our stakeholders and tenants to understand their requirements now, and we anticipate how these might change in future. From this knowledge, we evolve spaces so that they work optimally for our occupiers. We also prioritise the preservation of sound covenants to ensure low vacancies. By valuing and investing in human connections, we maximise long-term wealth creation and extract value for our stakeholders.

## **Innovation**

We innovate to realise the potential of space and collaborate with new partners, shifting the emphasis from assets to experiences that meet our clients' needs.





**30 Jellicoe,  
Rosebank,  
Gauteng**

# At a glance

30 Jellicoe is strategically situated on the corner of Jellicoe and Cradock Avenues in the heart of the Rosebank CBD, one of Northern Johannesburg's most desirable business nodes. The building is easily accessed from the M1 highway via the Glenhove off-ramp and is within walking distance of the Rosebank Gautrain station. It is conveniently located with access to all of Rosebank's shopping malls, banking facilities, restaurants and hotels.

It's home to Fluxman's head office and includes other tenants like TymeBank, Standard & Poor, and Novare – to name a few.



## Key Building Information

### Classification

AAA-grade office

### Total Building GLA

10 700m<sup>2</sup>

### Typical Floor Plate Size

1700m<sup>2</sup>

### Parking Ratio

5 bays per 100m<sup>2</sup>





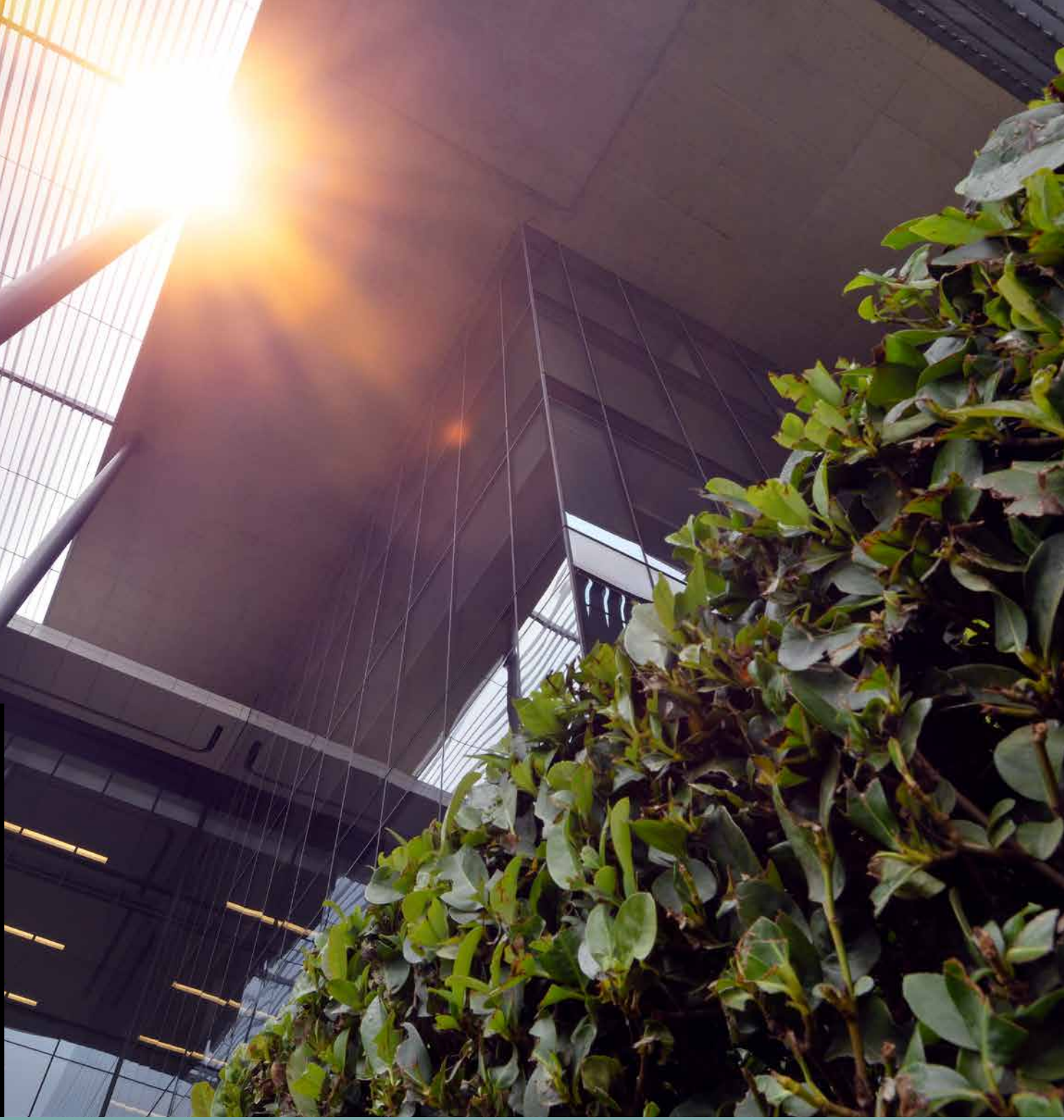

**Design  
Features**





# Design Features

## The office building design includes:

- Six levels of offices with four levels of basement parking.
- AAA grade spec and finishes throughout the building, particularly evident in the contemporary design of the lobbies and restrooms.
- Ideal building orientation to ensure optimal natural light within the office plate.
- Three access points to office areas ensure flexible tenant layouts, and easy circulation throughout the building.
- Detached louver walls for shading and external staircases are a striking feature of the modern architecture.
- Various green principles have been incorporated into the architectural design with energy efficient technology used in the electrical and mechanical features of the building.





# Locality Map





# Third Floor

## Key

- 1 Vacant Space
- 2 Lift
- 3 Common Area
- 4 Tenant
- Female Toilets
- Male Toilets
- Stairs
- Kitchen Area

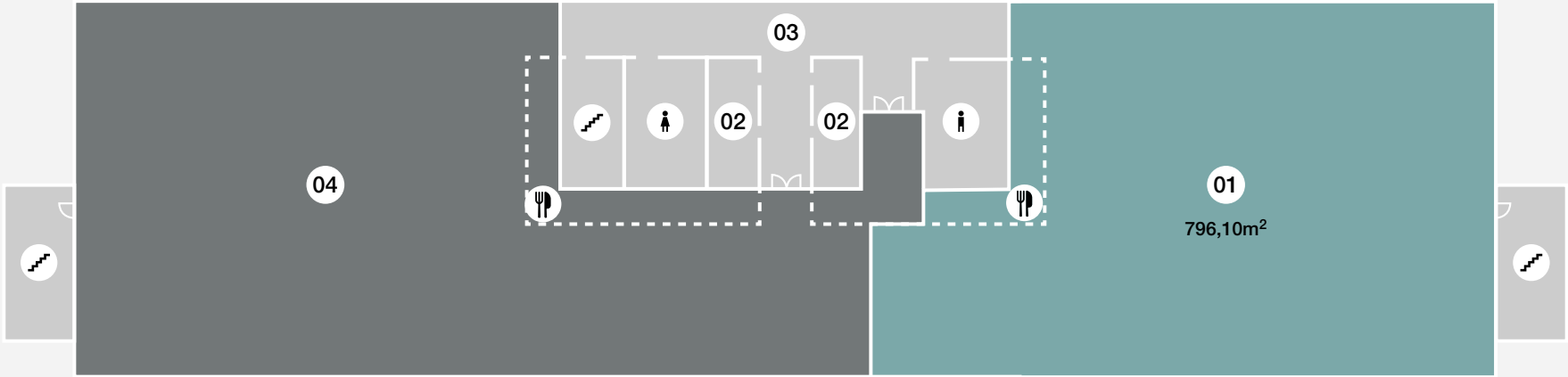

**Unlock the  
potential  
of space**





# Contact

## **Sazi Ndabeni**

011 263 5115

082 515 5062

sazi.ndabeni@investec.co.za

## **Dennis Helyar**

Leasing Consultant

083 604 0535

dennis.helyar@investec.co.za

**investecpropertyfund.com**

This brochure is issued by Investec Property (Pty) Ltd, as manager of Investec Property Fund Limited. The information contained in this document has not been independently verified. Accordingly, no representation or warranty express or implied, is being made or given as to the accuracy or completeness of the information or opinions and no responsibility is accepted for any such information or opinions. The information contained in this document is subject to completion, revision, verification and amendment without notice. This document is confidential and may not be reproduced (in whole or in part) or be disclosed to any third party without the prior written consent of Investec Property Proprietary Limited. Investec Property (Pty) Ltd, a company incorporated in South Africa, registration number 1947/025753/07. A member of the Investec Group and manager of Investec Property Fund Ltd. Investec Property Fund Limited, a company incorporated in South Africa with registration number 2008/011366/06, is a South African Real Estate Investment Trust (REIT), which listed on the Johannesburg Stock Exchange (JSE) in the Real Estate Holdings and Development sector. It is not collective investment scheme in terms of the Collective Investment Schemes Control Act No. 45 of 2002.

